



DESIGNER ELECTROL®

Automatic Electric Projection Screen Model

SPECIFICATION DATA

DA-LITE SCREEN COMPANY, INC.
3100 North Detroit Street
Post Office Box 137
Warsaw, Indiana 46581-0137
Phone: 574-267-8101
800-622-3737
Fax: 574-267-7804
Toll Free Fax: 877-325-4832
www.da-lite.com
e-mail: info@da-lite.com

SUGGESTED SPECIFICATIONS: _____ projection screen(s), _____ (H) x _____ (W), electrically operated 120 V (60 Hz) not more than 2.4 amp. Shall have specifically designed motor mounted inside the roller, to be three wire with ground quick reversal type, oiled for life, with automatic thermal overload cut-out, integral gears, capacitor and an electric brake to prevent coasting. To have pre-set but adjustable limit switches to automatically stop picture surface in the "up" and "down" positions. The roller to be rigid metal. Screen fabric to be seamless, flame retardant and mildew resistant fiberglass with black masking borders standard. Bottom of fabric shall be formed into a pocket holding a metal rod. Case to be wood finished in either veneer or laminate on all facing sides and painted on non-facing sides. The front of the case is easily removed for installation and access to motor limit switches and fabric. Sturdy mounting brackets installed for wall or ceiling installation. To be complete with three position control switch with cover plate. Screen to be listed by Underwriters' Laboratories.

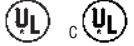

Matte White: Seamless in all standard sizes.

High Power®: Horizontal seam required when both dimensions exceed 6'.

VIDEO (NTSC 4:3) FORMAT DIMENSIONS (2" standard black drop at top)

Viewing Area		Nominal Diagonal		A - Overall Length of Case		B - Between Hanger Eyes		Approx. Ship. Wt.	
H x W	Cm	In.	Cm	In.	Cm	In.	Cm	Lbs.	Kg
50" x 67"	127 x 170	84"	213	81"	206	70"	178	56	25.4
60" x 80"	152 x 203	100"	254	95"	241	84"	213	67	30.4
69" x 92"	175 x 234	120"	305	107"	272	96"	244	77	34.9

SQUARE FORMAT DIMENSIONS

Sizes		A - Overall Length of Case		B - Between Hanger Eyes		Approx. Ship. Wt.	
H x W	Cm	In.	Cm	In.	Cm	Lbs.	Kg
70" x 70"	178 x 178	81"	206	70"	178	60	27.2
84" x 84"	213 x 213	95"	241	84"	213	70	31.8
96" x 96"	244 x 244	107"	272	96"	244	80	36.3

Specifications subject to change without notice.

Overall case length dimensions ±1/4".

Custom formats and sizes available upon request.

WHEN ORDERING, MARK APPROPRIATE SELECTIONS:

Select size from charts above.

Select viewing surface:

Matte White

High Power®

Greenguard® and Greenguard® Children and Schools Certified.

CASE STYLE:

- Concord
- Lexington
- Cambridge
- Hamilton
- Lancaster
- Yorkshire

FINISH:

- Laminate:**
- (Cambridge Only)
 - Figured Mahogany
 - Light Oak
 - Gunstock Walnut
 - Cherry
 - Custom

Veneer:

- Light Oak
- Medium Oak
- Natural Walnut
- Heritage Walnut
- Mahogany
- Cherry
- Honey Maple
- Custom

Optional Accessories:

- Single motor Low Voltage Control (LVC) - external.
- Wireless Remote Control for LVC.
 - Radio Frequency Remote Control.
 - Radio Frequency Range Extender available
 - Infrared Remote Control.
- Silent Motor.
- Key Locking Cover Plate for 120 V or LVC.
- Key Operated Switch for 120 V only (Cannot be used with LVC).
- No borders (Black masking borders standard).
- 220 Volt (50 Hz) motor.
- Video Projector Interface Control - external.
- External SCB-100 - RS-232 Serial Control Board
 - NET-100 Ethernet-Serial Adapter

Project:	_____
Architect:	_____
Phone:	_____
Contractor:	_____
Phone:	_____
Supervisor:	_____
Phone:	_____
Date:	_____
Revised:	_____

DESIGNER ELECTROL®

OVERALL LENGTH A = FABRIC WIDTH + 11" (28 Cm)
LENGTH B IS DISTANCE BETWEEN MOUNTING
HOLES ON BRACKETS AND IS THE FABRIC WIDTH.

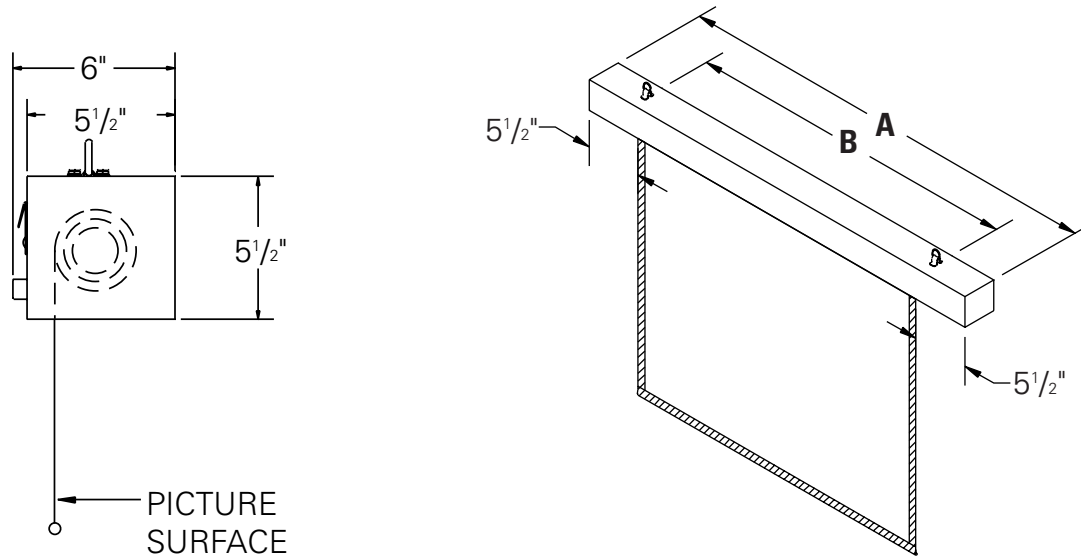

METHODS OF INSTALLATION

WALL MOUNTING

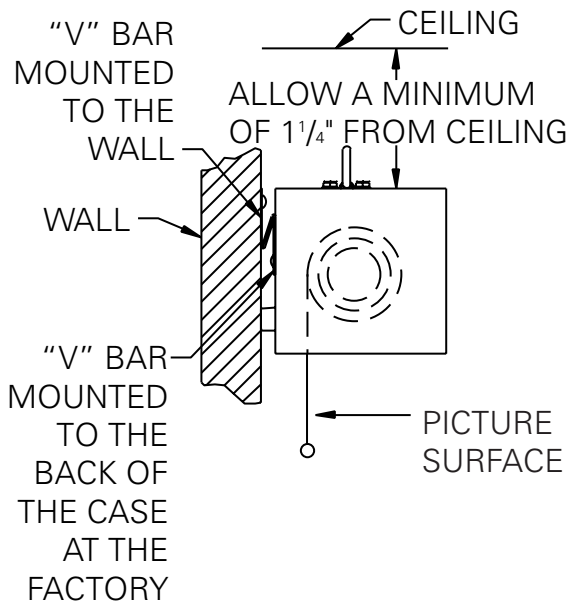

CEILING MOUNTING

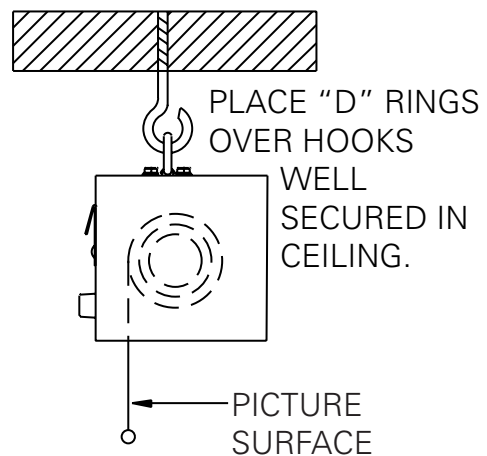



DESIGNER DA-TAB ELECTROL®

Automatic Electric Projection Screen Model

SPECIFICATION DATA

DA-LITE SCREEN COMPANY, INC.
3100 North Detroit Street
Post Office Box 137
Warsaw, Indiana 46581-0137
Phone: 574-267-8101
800-622-3737
Fax: 574-267-7804
Toll Free Fax: 877-325-4832
www.da-lite.com
e-mail: info@da-lite.com

SUGGESTED SPECIFICATIONS: _____ projection screen(s), _____ (H) x _____ (W), electrically operated 120 volt (60 Hz) not more than 2.4 amp. To have seamless surface with black masking borders standard on flame retardant and mildew resistant fabric mounted on rigid metal roller. Each side of the fabric to have tab guide cable system to maintain even lateral tension and hold surface flat. Custom slat bar with added weight maintains vertical tension on the screen surface. The ends of the slat to be protected by heavy duty plastic caps enclosing a preset adjustable mechanism for screen tensioning. Shall have specially designed motor mounted inside the roller, to be three wire with ground, quick reversal type, oiled for life, with automatic thermal overload cutout, integral gears, capacitor and an electric brake to prevent coasting. To have preset but adjustable limit switches to automatically stop picture surface in the "up" and "down" position. Case to be wood finished in either veneer or laminate on all facing sides and painted on non-facing sides. The front of the case is easily removed for installation and access to motor limit switches and fabric. Sturdy mounting brackets installed for wall or ceiling installation. The front of the case is easily removed for installation and access to motor limit switches and fabric. To be complete with three position control switch with cover plate. Screen to be listed by Underwriters' Laboratories.

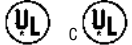

All viewing surfaces will be seamless.

All viewing surfaces are standard with black backing except Da-Tex® and Dual Vision.

VIDEO FORMAT DIMENSIONS

Viewing Area		Nominal Diagonal		A – Overall Length of Case		B – Between Hanger Eyes		Approx. Ship. Wt.	
H x W	Cm	In.	Cm	In.	Cm	In.	Cm	Lbs.	Kg
43" x 57"	109 x 145	72"	183	78"	198	60"	152	80	36.3
50" x 67"	127 x 170	84"	213	89"	226	70"	178	90	40.8
60" x 80"	152 x 203	100"	254	103"	262	84"	213	105	47.6
69" x 92"	175 x 234	120"	305	117"	297	96"	244	120	54.4

All sizes come standard with 12" of black extra drop at the top.

Extra drop may alter case dimensions. Contact Da-Lite for details.

Overall case length dimensions $\pm 1/4$ ".

Specifications subject to change without notice.

Custom formats and sizes available upon request.

WHEN ORDERING, MARK APPROPRIATE SELECTIONS:

Select size from chart above.

Select viewing surface:

- Da-Mat®
- Pearlescent
- Audio Vision
- Dual Vision
- High Contrast Audio Vision
- High Contrast Da-Mat®
- Cinema Vision
- Da-Tex® (Rear)
- High Contrast Cinema Vision
- High Contrast Cinema Perf

CASE STYLE:

- Concord
- Lexington
- Cambridge
- Hamilton
- Lancaster
- Yorkshire

FINISH:

Laminate:

- (Cambridge Only)
- Figured Mahogany
- Light Oak
- Gunstock Walnut
- Cherry
- Custom

Veneer:

- Light Oak
- Medium Oak
- Natural Walnut
- Heritage Walnut
- Mahogany
- Cherry
- Honey Maple
- Custom

Options:

- Single motor Low Voltage Control (LVC) - external.
- Wireless Remote Control for LVC.
 - Radio Frequency Remote Control.
 - Radio Frequency Range Extender available
 - Infrared Remote Control.
- Silent Motor.
- Key Locking Cover Plate for 120V or LVC.
- Key Operated Switch for 120V only (NOTE: Cannot be used with LVC).
- 220 Volt (50 Hz) Motor.
- Video Projector Interface Control - external.
- External SCB-100 - RS-232 Serial Control Board
 - NET-100 Ethernet-Serial Adapter

Project:	_____
Architect:	_____
Phone:	_____
Contractor:	_____
Phone:	_____
Supervisor:	_____
Phone:	_____
Date:	_____
Revised:	_____

DESIGNER DA-TAB ELECTROL®

Overall length A = fabric width + 18"
Length B is the distance between the mounting holes, and the fabric width.

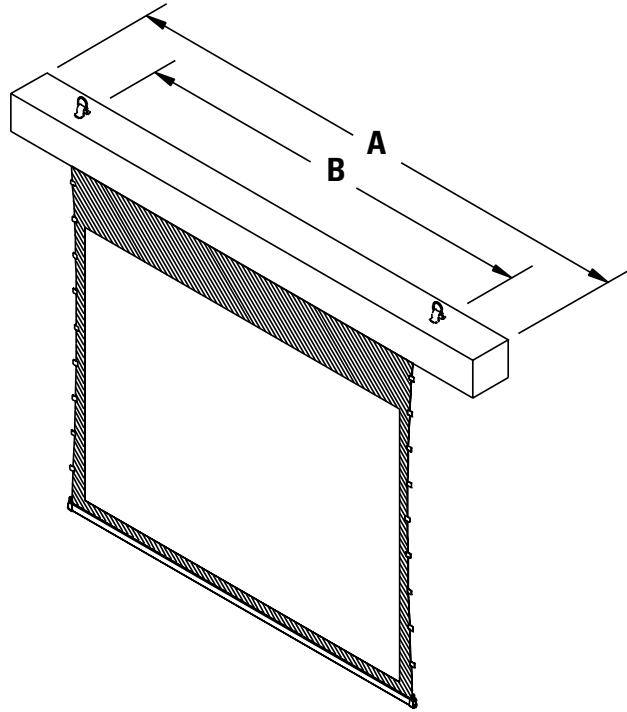
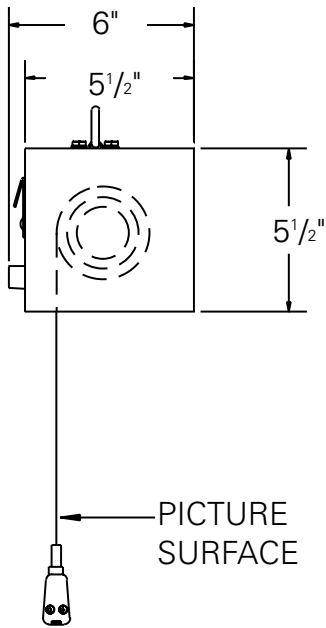

METHODS OF INSTALLATION

WALL MOUNTING

Slip hanger eyes over screws well secured in wall.

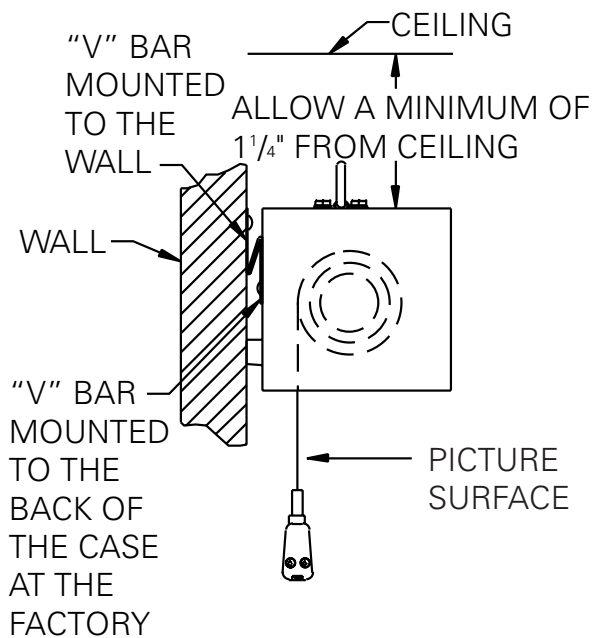

CEILING MOUNTING

Place "D" rings over hooks well secured in ceiling.

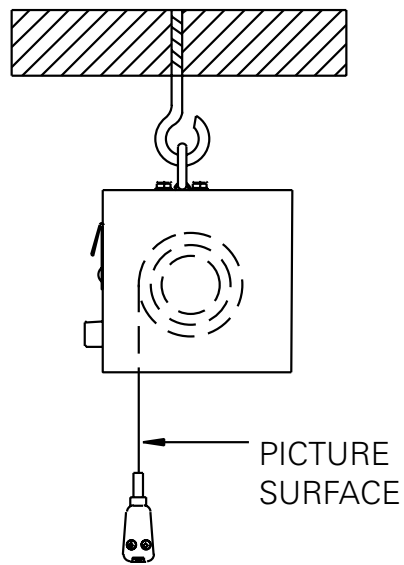



DESIGNER CINEMA ELECTROL®

Automatic Electric Projection Screen Model

SPECIFICATION DATA

DA-LITE SCREEN COMPANY, INC.
3100 North Detroit Street
Post Office Box 137
Warsaw, Indiana 46581-0137
Phone: 574-267-8101
800-622-3737
Fax: 574-267-7804
Toll Free Fax: 877-325-4832
www.da-lite.com
e-mail: info@da-lite.com

SUGGESTED SPECIFICATIONS: _____ projection screen(s), _____ (H) x _____ (W), electrically operated 120 volt (60 Hz) not more than 1.2 amp. Shall have specially designed motor mounted inside the roller, to be three wire with ground, quick reversal type, oiled for life, with an automatic thermal overload cutout, integral gears, capacitor and an electric brake to prevent coasting. To have preset but adjustable limit switches to automatically stop the picture surface in the "up" and "down" positions. The roller to be of rigid metal. Roller mounting brackets to be adjustable to allow centering or offsetting of the screen within the case. Screen case to be a two piece design made of extruded aluminum. Case to be finished in white, lightly textured powder coat. Screen fabric to be flame retardant and mildew resistant fiberglass with black masking borders standard. Bottom of fabric shall be formed into a pocket holding a metal rod. Screen to include a control cable with operating switch built into line and power cable (two wire plus ground) to 3-prong plug. Screen to be listed by Underwriters' Laboratories.

Matte White, High Contrast Matte White and Video Spectra 1.5: Seamless in all sizes.

High Power®: Horizontal seam required when both dimensions exceed 6'.

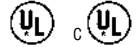

VIDEO (NTSC 4:3) FORMAT DIMENSIONS (2" standard black drop at top)

Viewing Area		Nominal Diagonal		Overall Length of Case		Approx. Ship. Wt.	
H x W	Cm	In.	Cm	In.	Cm	Lbs.	Kg
43" x 57"	109 x 145	72"	183	69 1/4"	176	34	15.4
50" x 67"	127 x 170	84"	213	79 1/4"	201	37	16.8
57" x 77"	145 x 196	96"	244	93 1/4"	237	42	19.1
60" x 80"	152 x 203	100"	254	93 1/4"	237	42	19.1
69" x 92"	175 x 234	120"	305	105 1/4"	267	47	21.3

HDTV (16:9) FORMAT DIMENSIONS (2" standard black drop at top)

Viewing Area		Nominal Diagonal		Overall Length of Case		Approx. Ship. Wt.	
H x W	Cm	In.	Cm	In.	Cm	Lbs.	Kg
37 1/2" x 67"	95 x 170	77"	196	79 1/4"	201	37	16.8
45" x 80"	114 x 203	92"	234	93 1/4"	237	42	19.1
52" x 92"	132 x 234	106"	269	105 1/4"	267	47	21.3

SQUARE FORMAT DIMENSIONS (screens with ^ have 2" standard black drop at top)

Sizes		Overall Length of Case		Approx. Ship. Wt.	
H x W	Cm	In.	Cm	Lbs.	Kg
50" x 50"	127 x 127	59 1/4"	150	28	12.7
60" x 60"	152 x 152	69 1/4"	176	34	15.4
70" x 70"	178 x 178	79 1/4"	201	37	16.8
84" x 84"	213 x 213	93 1/4"	237	42	19.1
6' x 8'^^	183 x 244	105 1/4"	267	47	21.3
8' x 8'	244 x 244	105 1/4"	267	48	21.8

Overall case length dimensions ± 1/4".

Detail dimensional drawings and installation instructions available upon request.

Specifications subject to change without notice.

Custom formats and sizes available upon request.

WHEN ORDERING, MARK APPROPRIATE SELECTIONS:

Select size from charts on the other side.

Select viewing surface:

- Matte White 
- High Contrast Matte White 
- High Power 
- Video Spectra 1.5 

 Greenguard® and Greenguard® Children and Schools Certified.

Optional Accessories:

- No borders (Black masking borders standard).
- 220 Volt (50 Hz) Motor.
- Veneer Case Cover (Choose from seven standard veneers).
 - Light Oak
 - Medium Oak
 - Natural Walnut
 - Heritage Walnut
 - Mahogany
 - Cherry
 - Honey Maple
- Graphite case color.
- Black case (white standard).

Project:	_____
Architect:	_____
Phone:	_____
Contractor:	_____
Phone:	_____
Supervisor:	_____
Phone:	_____
Supplier:	_____
Date:	_____
Revised:	_____

DESIGNER CINEMA ELECTROL®

METHODS OF INSTALLATION

CEILING/HOOK MOUNT BRACKET

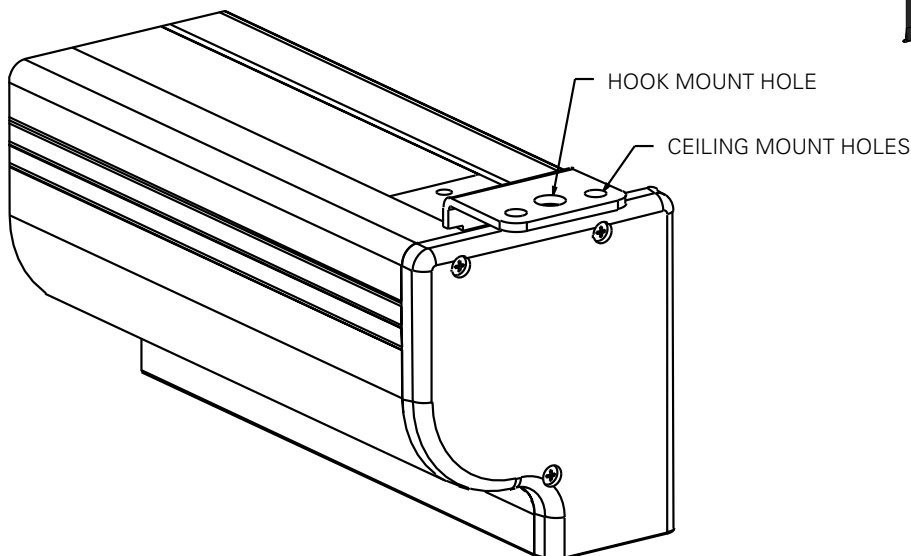
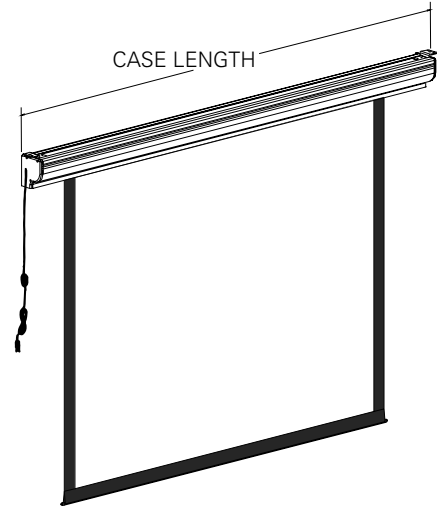
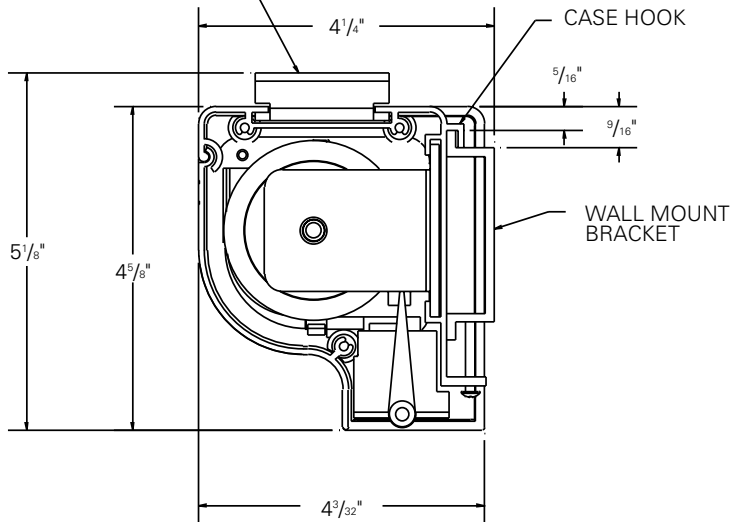



DESIGNER MANUAL SCREEN

SPECIFICATION DATA

DA-LITE SCREEN COMPANY, INC.
 3100 North Detroit Street
 Post Office Box 137
 Warsaw, Indiana 46581-0137
 Phone: 574-267-8101
 800-622-3737
 Fax: 574-267-7804
 Toll Free Fax: 877-325-4832
 www.da-lite.com
 e-mail: info@da-lite.com

SUGGESTED SPECIFICATIONS: _____ projection screen(s), _____ (H) x _____ (W), wall or ceiling mounting type. Screen fabric to be seamless flame retardant and mildew resistant fiberglass with black masking borders standard. Bottom of fabric shall be mounted securely into a powder coated tubular steel slat. Ends of slat shall be protected by plastic outer caps. Steel slat pull shall be attached to slat with screws. Fabric shall be mounted into a metal strip in a metal Camlok® roller system without tape, glue, staples or cords so that the fabric may be easily replaced yet cannot be pulled from the roller. Case to be plywood and/or hardwood depending on style. Finished in veneer on all facing sides and painted on nonfacing sides. Sturdy mounting brackets installed for wall or ceiling installation. A 36" pull cord with plastic knob is included.

Matte White: Surfaces will be seamless.

High Power®: Horizontal seam required when both dimensions exceed 6'.

VIDEO (NTSC 4:3) FORMAT DIMENSIONS

Viewing Area		Nominal Diagonal		A - Overall Length of Case		B - Between Hanger Eyes		Approx. Ship. Wt.	
H x W	Cm	In.	Cm	In.	Cm	In.	Cm	Lbs.	Kg
50" x 67"	127 x 170	84"	213	77"	196	70"	178	29	13.2
60" x 80"	152 x 203	100"	254	91"	231	84"	213	32	14.5
69" x 92"	175 x 234	120"	305	103"	262	96"	244	39	17.7

SQUARE FORMAT DIMENSIONS

Sizes		A - Overall Length of Case		B - Between Hanger Eyes		Approx. Ship. Wt.	
H x W	Cm	In.	Cm	In.	Cm	Lbs.	Kg
70" x 70"	178 x 178	77"	196	70"	178	29	13.2
84" x 84"	213 x 213	91"	231	84"	213	32	14.5
96" x 96"	244 x 244	103"	262	96"	244	39	17.7

Specifications subject to change without notice.
 Overall case length dimensions ±1/4".
 Custom formats and sizes available upon request.

PLEASE MARK APPROPRIATE SELECTIONS:

Select size from chart above:

Select viewing surface:

- Matte White
- High Power®
- Greenguard® and Greenguard® Children and Schools Certified.

Options:

- No borders (Black masking borders standard.)
- Pull Rod - 38".

Style:

- Concord
- Lexington
- Hamilton

Finish:

- Veneer
- Cherry
- Light Oak
- Medium Oak
- Mahogany
- Natural Walnut
- Heritage Walnut
- Honey Maple
- Custom

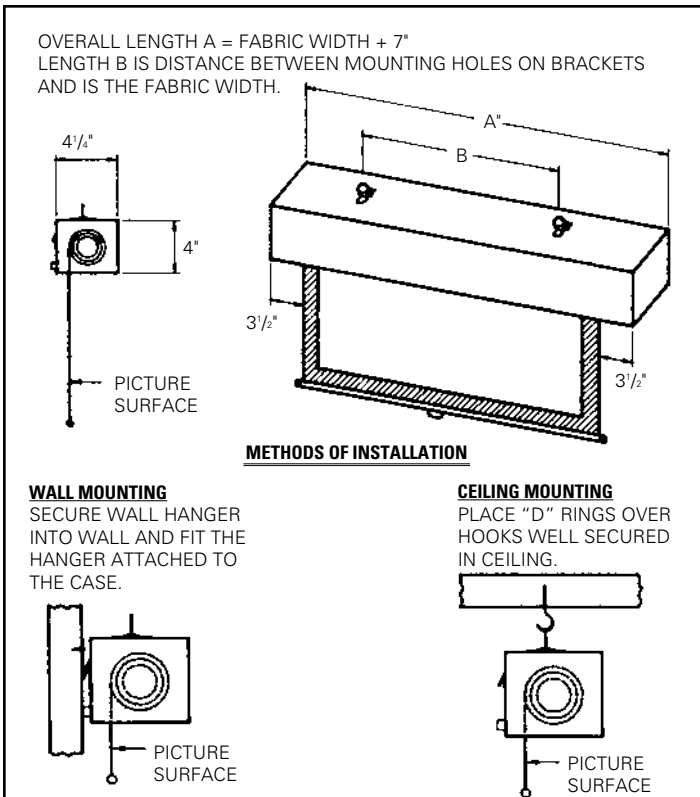

Project: _____

Architect: _____

Phone: _____

Contractor: _____

Phone: _____

Supervisor: _____

Phone: _____

Date: _____

Revised: _____